



symbolic image



Function

1 pole residual current operated circuit-breakers with integral overcurrent protection (RCBO) for implementing the protective measure "Automatic disconnection of the power supply" as per BS 7671 - 411 and overcurrent protection as per 431.

Features

1 protected pole with solid neutral design for all rated currents, green/red switching position indicator, strain-relief clamps with protection against wires being lodged behind them, bi-stable snap-in slider for easy mounting and removal.

Mounting

Quick fastening to mounting rail, any installation position.

Applications

Designed for domestic and commercial applications using single pole switching of the live conductor, in the event of a fault the neutral conductor remains connected to the supply.

Short circuit capacity up to 10 kA, available in B or C MCB characteristic.

Sensitive to 50 Hz AC residual currents and pulsating DC residual currents (type A) .

Technical Data

Technical Data	RCBO 1 B or C ** /0,03/1-A
Series	RCBO 1
Number of poles	1
Residual current type	A
Rated current (AC)	Refer to the individual product reference, data sheet available on request
Rated residual current I Δ n	0.03 A
Short-time delayed	false
Selective	false
min. Operating voltage range of test circuit	184 V
max. Operating voltage range of test circuit	264 V
Neutral conductor position	right

Technical Data	RCBO 1 B or C ** /0,03/1-A
Tripping characteristic	B or C
Operating voltage (AC)	max. 253 V
	Load circuit
Specification	Load switch contact
Rated voltage (AC)	230 V
Rated current (AC)	Refer to the individual product reference, data sheet available on request
Rated short-circuit current	10 kA
Surge current strength	0.25 kA
max. Output O1 total rated switching capacity	10 kA
Rated frequency	50 Hz
Current heat loss per current path	Refer to the individual product reference, data sheet available on request
short-circuit backup-fuse SCPD	100 A
Back-up fuse type	gG
	Screw-type terminal top, bottom (Load circuit)
Clamping area	1 mm ² ... 25 mm ²
Connection C1 Maximum number of conductors per terminal	2 (conductors of same type and cross-section)
General data description	General data
Operating position	any
Mechanical endurance	min. 20000 cycles
Electrical endurance	min. 4000 cycles
Storage temperature	-25 °C ... 55 °C
Ambient temperature	-25 °C ... 40 °C
Climate resistance	according to IEC 60068-2 (90...95%)
Housing type	Distributor housing
Mounting type	Mounting rail
Housing material	Thermoplastic resin
Protection class	IP20 (installed: IP40)
Width	17.7 mm
Height	102.6 mm
Depth	75.2 mm
Installation depth	70.2 mm
Width (modules)	1
Design requirements/Standards	EN 61009-1, EN 61009-2-1, EN 61543
Energy limiting class	3

Dimensions

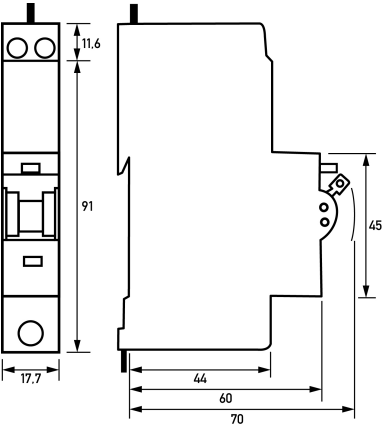

Dimensional drawing Group view

Wiring example

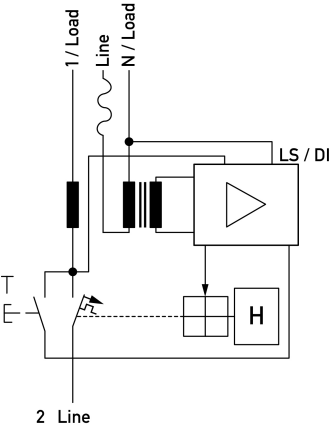

Wiring diagram