

Innovative, New Generation DLS6 Breakers

These all new modular devices are contact safe for the back of the hand. The modern functional design and the high grade surface finish of the plastic components are indicative of the high quality standard of this new range of miniature circuit breakers.

The DIN-rail clip enables the MCB's to be removed easily and quickly from the DIN-rail without the need to remove the busbar from the remaining fixed modular devices. The MCB's will accept both pin and fork busbar, the box terminals have a capacity of 25mm².

A large window with flip-down opening enables clear permanently protected labelling of the device.



The Type "B" Range of Miniature Circuit Breakers

This range is used to provide protection and control of circuits against overload and short circuit in domestic installations. Manufactured to BSEN 60898 the single & double pole versions are rated at 6kA and are used extensively in all our consumer boards. The triple pole MCBs are rated at 10kA for added protection.

MCBs Type "B" 6kA Single & Double Pole & 10kA Triple Pole								
Rating	Breaking Capacity	SINGLE POLE		DOUBLE POLE		Breaking Capacity	TRIPLE POLE	
		Modules	Reference	Modules	Reference		Modules	Reference
6A	6kA	1	HB6/1	2	HB6/2	10kA	3	IB6/3
10A	6kA	1	HB10/1	2	HB10/2	10kA	3	IB10/3
16A	6kA	1	HB16/1	2	HB16/2	10kA	3	IB16/3
20A	6kA	1	HB20/1	2	HB20/2	10kA	3	IB20/3
25A	6kA	1	HB25/1	2	HB25/2	10kA	3	IB25/3
32A	6kA	1	HB32/1	2	HB32/2	10kA	3	IB32/3
40A	6kA	1	HB40/1	2	HB40/2	10kA	3	IB40/3
50A	6kA	1	HB50/1	2	HB50/2	10kA	3	IB50/3
63A	6kA	1	HB63/1	2	HB63/2	10kA	3	IB63/3

The Type C 10kA Range is used to provide protection and control of circuits against overload and short circuit in commercial and industrial electrical distribution systems. This is the most popular type for use in our TPN boards.

MCBs Type "C" 10kA Single & Double Pole & Triple Pole							
Rating	Breaking Capacity	SINGLE POLE		DOUBLE POLE		TRIPLE POLE	
		Modules	Reference	Modules	Reference	Modules	Reference
0.5A	10kA	1	IC0.5/1	2	IC0.5/2	3	IC0.5/3
1A	10kA	1	IC1/1	2	IC1/2	3	IC1/3
2A	10kA	1	IC2/1	2	IC2/2	3	IC2/3
4A	10kA	1	IC4/1	2	IC4/2	3	IC4/3
6A	10kA	1	IC6/1	2	IC6/2	3	IC6/3
10A	10kA	1	IC10/1	2	IC10/2	3	IC10/3
16A	10kA	1	IC16/1	2	IC16/2	3	IC16/3
20A	10kA	1	IC20/1	2	IC20/2	3	IC20/3
25A	10kA	1	IC25/1	2	IC25/2	3	IC25/3
32A	10kA	1	IC32/1	2	IC32/2	3	IC32/3
40A	10kA	1	IC40/1	2	IC40/2	3	IC40/3
50A	10kA	1	IC50/1	2	IC50/2	3	IC50/3
63A	10kA	1	IC63/1	2	IC63/2	3	IC63/3

The Type "D" 10kA Range provides protection and control of circuits against overload and short circuit in industrial electrical distribution systems. Used in the TPN boards, this range will provide protection for equipment with surge currents especially motors.

MCBs Type "D" 10kA Single & Double Pole & Triple Pole							
Rating	Breaking Capacity	SINGLE POLE		DOUBLE POLE		TRIPLE POLE	
		Modules	Reference	Modules	Reference	Modules	Reference
6A	10kA	1	ID10.6/1	2	ID6/2	3	ID6/3
10A	10kA	1	ID10.10/1	2	ID10/2	3	ID10/3
16A	10kA	1	ID10.16/1	2	ID16/2	3	ID16/3
20A	10kA	1	ID10.20/1	2	ID20/2	3	ID20/3
25A	10kA	1	ID10.25/1	2	ID25/2	3	ID25/3
32A	10kA	1	ID10.32/1	2	ID32/2	3	ID32/3
40A	10kA	1	ID10.40/1	2	ID40/2	3	ID40/3
50A	10kA	1	ID10.50/1	2	ID50/2	3	ID50/3
63A	10kA	1	ID10.63/1	2	ID63/2	3	ID63/3



Doepke *Leading the Way*

MINIATURE CIRCUIT BREAKERS *continued*

Accessories for the DLS6 range of breakers

The DHi auxiliary contact switches can be added to MCBs to give volt free contacts that indicate the state of the device. Adding the DASA shunt trip to an MCB gives automatic tripping when 230V mains is applied to the tripping coil.

Connection of these devices is by a pin into the side of the adjoining device and a clip top and bottom.

Auxiliary / Fault Signal Switches & Shunt Trip		
Module	Contacts	Reference
0.5	1 x normally open	DHi-3
0.5	1 x normally open 1 x normally closed	DHi-4
1.0	1.5A max	DASA-230

To avoid reconnection during maintenance or repair work. Avoids the possibility of accidental connection to mains voltage.

Locking Facility	
Description	Reference
Lockable with padlock (not supplied)	DEASS



High Current Rating MCBs Type "C"

These specialised MCBs are 3 & 4 pole units built to a 27mm module size with ratings of 80, 100 & 125 Amps. They are specialist stand alone devices, which do not fit into standard consumer units or pan assemblies.



High Rating Type "C"			
Rating	Breaking Capacity	Triple Pole Reference	Four Pole Reference
80A	10kA	C10.80/3	C10.80/4
100A	10kA	C10.100/3	C10.100/4
125A	10kA	C10.125/3	C10.125/4

Circuit Protection

TECHNICAL SPECIFICATIONS

Miniature Circuit Breakers

Technical Data

Specifications	EN 60898
Rated breaking capacity	Characteristic B 10 kA, 6-63 A Characteristic C 10 kA, 0,5-63 A Characteristic D 10 kA, 10-32 A
Max. operating voltage	$U_{Bmax} = 440$ V AC
Min. operating voltage	$U_{Bmin} = 12$ V AC, 12 V DC
Surge voltage	5 kV (1,2/50 ms)
Surge AC voltage	3 kV (50 to 60 Hz)
Back-up protection	provided by 100 A gL back-up fuse for prospective short-circuit current up to 100 kA
Enclosure protection type (DIN 40 050)	IP 20, with cover IP 40
Positioning	optional
Quick-mounting	for mounting on rail conforming to EN 50022
Mech. service life	min. 20.000 switching cycles
Electr. service life	min. 20.000 switching cycles at $I_n < 32$ A min. 10.000 switching cycles at $I_n < 32$ A
Ambient temperature	$T_{max.} = +55^{\circ}C, T_{min.} = -25^{\circ}C$
Daily average	$< +35^{\circ}C$

Dimensions

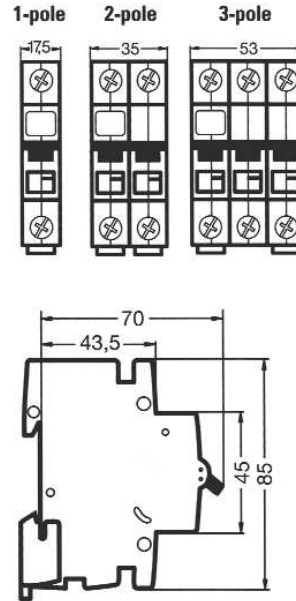

Tripping Characteristics

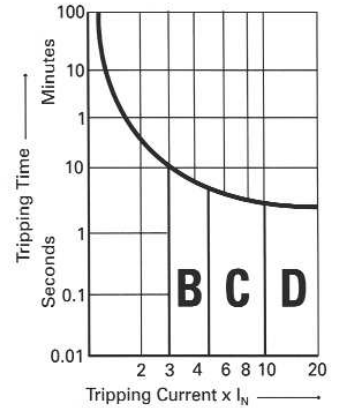

Miniature Circuit Breakers (80 - 125A)

Technical Data

Specifications	EN 60 898
Tripping Characteristics	"C"
Rated voltage	230 V, 40/60 Hz
DC voltage	48 V, 440 V
Breaking capacity	10kA ($t > = 5$ ms)
Ambient temperature	-30°C to +55°C
Connection	1.5 - 50 mm ² , 2 x (1.5 - 16mm ²)

Dimensions

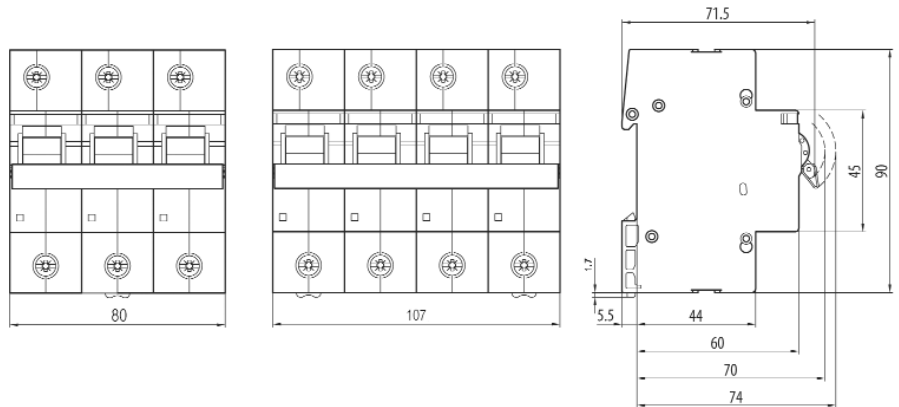

Single Pole & Neutral MCB's

Technical Data

Specifications	EN 60 89 (IEC 898)
Connection	1-10 mm ² (lift terminal)
Rated voltage Un	230 V, 50/60 Hz
Rated breaking capacity	6 - 20 A for 6 kA, 25/30 A for 4,5 kA
DC voltage	max. 50 V
Max. back-up fuse	100 A gL
Selectivity class	3
Ambient temperature	-5°C to +40°C
Protection against direct contact	Safe for finger and back of the hand contact
Enclosure protection type	IP 40, built-in switch

Dimensions

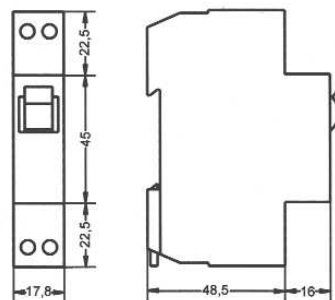

Contact Assignments

