

## The residual current circuit breakers with overload

have been designed to combine earth leakage and overload protection in one compact unit. All have a sensitivity setting of 30mA and are available in various current ratings. This protection device is suitable for domestic, commercial and industrial applications.



The single module RCBO is an electronic unit designed specifically for fitting into consumer units (plastic and metal) to give earth leakage protection to an individual circuit.

| RCBOs Single Module (+ un-switched neutral) 6kA Rated |             |                    |                    |
|---|-------------|--------------------|--------------------|
| Amps  | Sensitivity | Reference 'B' Type | Reference 'C' Type |
| 6   | 30mA        | FIB.6-1/30         | FIC.6-1/30         |
| 10  | 30mA        | FIB.10-1/30        | FIC.10-1/30        |
| 16  | 30mA        | FIB.16-1/30        | FIC.16-1/30        |
| 20  | 30mA        | FIB.20-1/30        | FIC.20-1/30        |
| 32  | 30mA        | FIB.32-1/30        | FIC.32-1/30        |
| 40  | 30mA        | FIB.40-1/30        | FIC.40-1/30        |

| RCBOs Two Pole |             | 10kA Rated         |                    |
|----------------|-------------|--------------------|--------------------|
| Amps           | Sensitivity | Reference 'B' Type | Reference 'C' Type |
| 6              | 30mA        | FIB.6-2/30         | FIC.6-2/30         |
| 10             | 30mA        | FIB.10-2/30        | FIC.10-2/30        |
| 16             | 30mA        | FIB.16-2/30        | FIC.16-2/30        |
| 20             | 30mA        | FIB.20-2/30        | FIC.20-2/30        |
| 25             | 30mA        | FIB.25-2/30        | FIC.25-2/30        |
| 32             | 30mA        | FIB.32-2/30        | FIC.32-2/30        |
| 40             | 30mA        | FIB.40-2/30        | FIC.40-2/30        |

| RCBOs Four Pole |             | 10kA Rated         |
|-----------------|-------------|--------------------|
| Amps            | Sensitivity | Reference 'C' Type |
| 6               | 30mA        | FIC.6-4/30         |
| 10              | 30mA        | FIC.10-4/30        |
| 16              | 30mA        | FIC.16-4/30        |
| 20              | 30mA        | FIC.20-4/30        |
| 25              | 30mA        | FIC.25-4/30        |
| 32              | 30mA        | FIC.32-4/30        |

The two and four module RCBOs have flag indicators to show the position of the contacts, they also have terminals capable of accepting 25mm<sup>2</sup> cable.

Busbar connections to the two or four module DIN-rail mounted units are both fork and pin.

The RCBOs respond to both AC and pulsating DC residual currents and are manufactured to comply with BSEN61008.



Circuit Protection

# TECHNICAL SPECIFICATIONS

## Residual Current Breaker with Overload - single pole

### Technical Data

|                          |   |
|--------------------------|---|
| Connection               | Incoming - Live 1-25mm <sup>2</sup> cable & fork busbar<br>- Neutral flying lead rated at 56Amps<br>Outgoing - 1-10mm <sup>2</sup> Live & Neutral |
| Standards                | BSEN61009<br>BSEN61009-2-1<br>BSEN61543   |
| Current rating           | 6A - 40A  |
| Operating Voltage        | 230 V a.c.  |
| No. of poles             | 2 (solid neutral)   |
| Tripping Characteristics | Type C  |
| Energy limiting class    | 3   |
| RCD type                 | Type A -Standard  |
| Tripping sensitivity     | 30mA  |
| Short circuit rating     | 6kA   |

### Dimensions

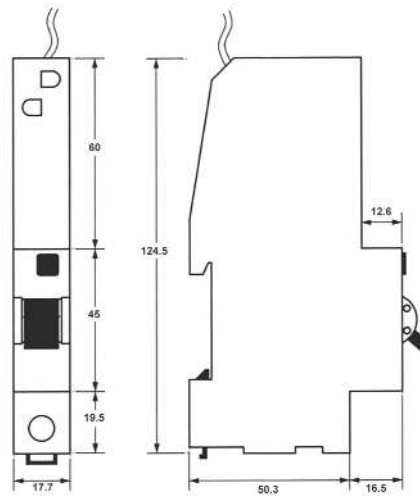

### Contact Assignments

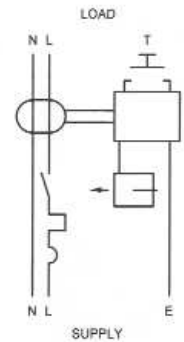

## Residual Current Breaker with Overload - 2 pole

### Technical Data

|                         |   |
|-------------------------|---|
| Connection              | 1-25mm <sup>2</sup>   |
| Ambient temperature     | climatic-proof as per IEC 1008  |
| Max. back-up fuse       | 100 gL  |
| Rated breaking capacity | 10 kA as per IEC 1009 (EN 61 009)   |
| Energy limiting class   | 3   |
| Rated frequency         | 50 Hz   |
| Responds to             | AC and pulsating DC residual currents   |
| Operating voltage       | $U_B \sim 230\text{ V}$<br>$U_{Bmin.} \sim 100\text{ V}$ for the test circuit |
| No. of modules          | 2   |

### Dimensions

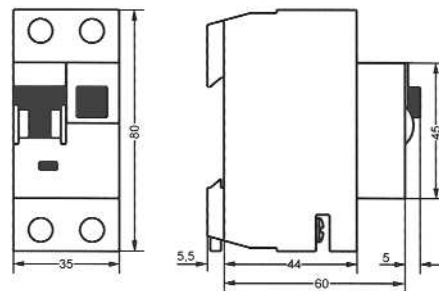

### Contact Assignments

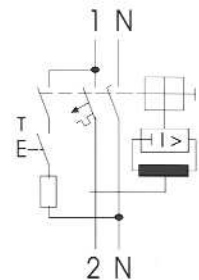

## Residual Current Breaker with Overload - 4 pole

### Technical Data

|                         |   |
|-------------------------|---|
| Connection              | 1-25mm <sup>2</sup>   |
| Ambient temperature     | climatic-proof as per IEC 1008  |
| Max. back-up fuse       | 100 gL  |
| Rated breaking capacity | 6 kA as per EN 61 009-1   |
| Energy limiting class   | 3   |
| Rated frequency         | 50 Hz   |
| Responds to             | AC and pulsating DC residual currents   |
| Operating voltage       | $U_B \sim 400\text{ V}$<br>$U_{Bmin.} \sim 100\text{ V}$ for the test circuit |
| No. of modules          | 4   |

### Dimensions

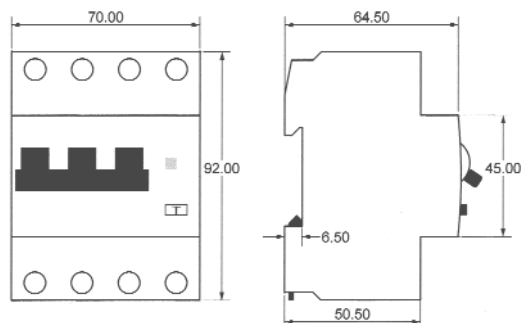

### Contact Assignments

